

**TYPICAL SECTION**

**NOTES:**

1. This drawing illustrates the concepts to be used for modular wall installations regarding warning sign placement, clear space requirements, geogrid protection, and the need to obtain an encroachment agreement prior to construction. This detail does not constitute a structural design. Full construction plans for retaining walls must be sealed by a Professional Engineer licensed in North Carolina and submitted to the Town during the plan review process.
2. Placement of any portion of a modular retaining wall in the right-of-way (R/W) shall require an encroachment agreement to be executed with the Town prior to construction.
3. Handrails shall extend through the protected area and warning signs shall be attached to the handrail at each end of the protected area.
4. Additional measure(s) may be required by the Town.
5. This detail applies only to streets maintained (or to-be-maintained) by the Town of Clayton. Use of this detail on an existing NCDOT-Maintained roadway, or along one that would need to be maintained by NCDOT, occurs at the developer's own risk. Such retaining walls need the approval of NCDOT.
6. The Town prefers that all retaining walls and appurtenances be located outside of the R/W in order to provide adequate space for utilities (aerial and underground), landscaping, sidewalks, and other items.



**TOWN of CLAYTON**

USE WITH THE TOWN of CLAYTON STANDARD SPECIFICATIONS ONLY

**SEGMENTAL RETAINING WALLS  
IN RIGHT-OF-WAY**

SCALE: Not To Scale	DETAIL # 2406.01
REVISION DATE: July, 2010	SHEET #: 1 of 3



# WARNING SIGN DETAIL

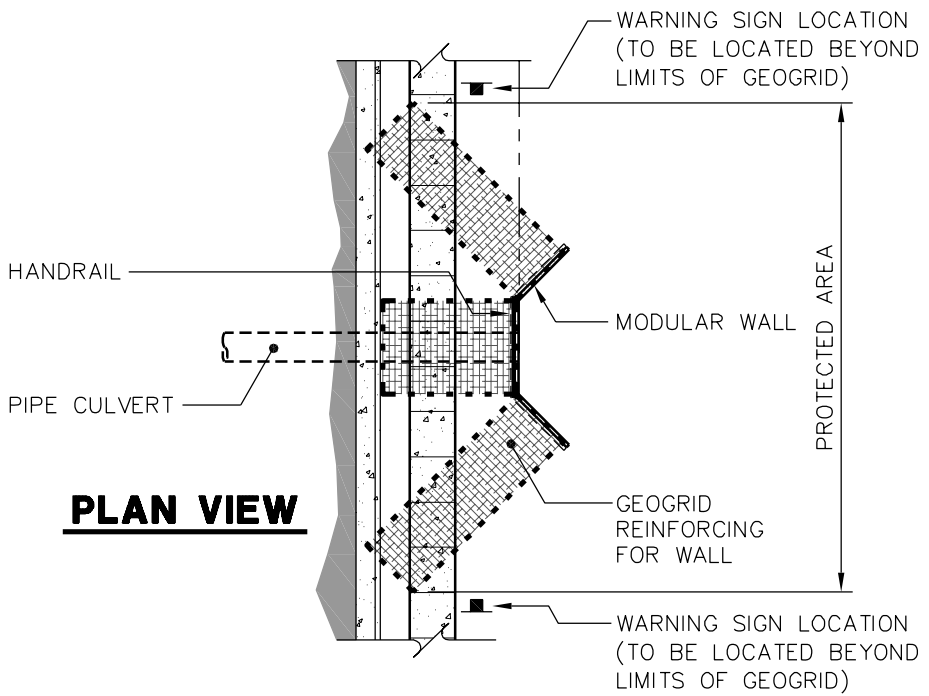

## TOWN of CLAYTON

USE WITH THE TOWN of CLAYTON STANDARD SPECIFICATIONS ONLY

# SEGMENTAL RETAINING WALLS IN RIGHT-OF-WAY

SCALE:  
Not To Scale

DETAIL #  
2 406.01

REVISION DATE:  
July, 2010

SHEET #:  
2 of 3

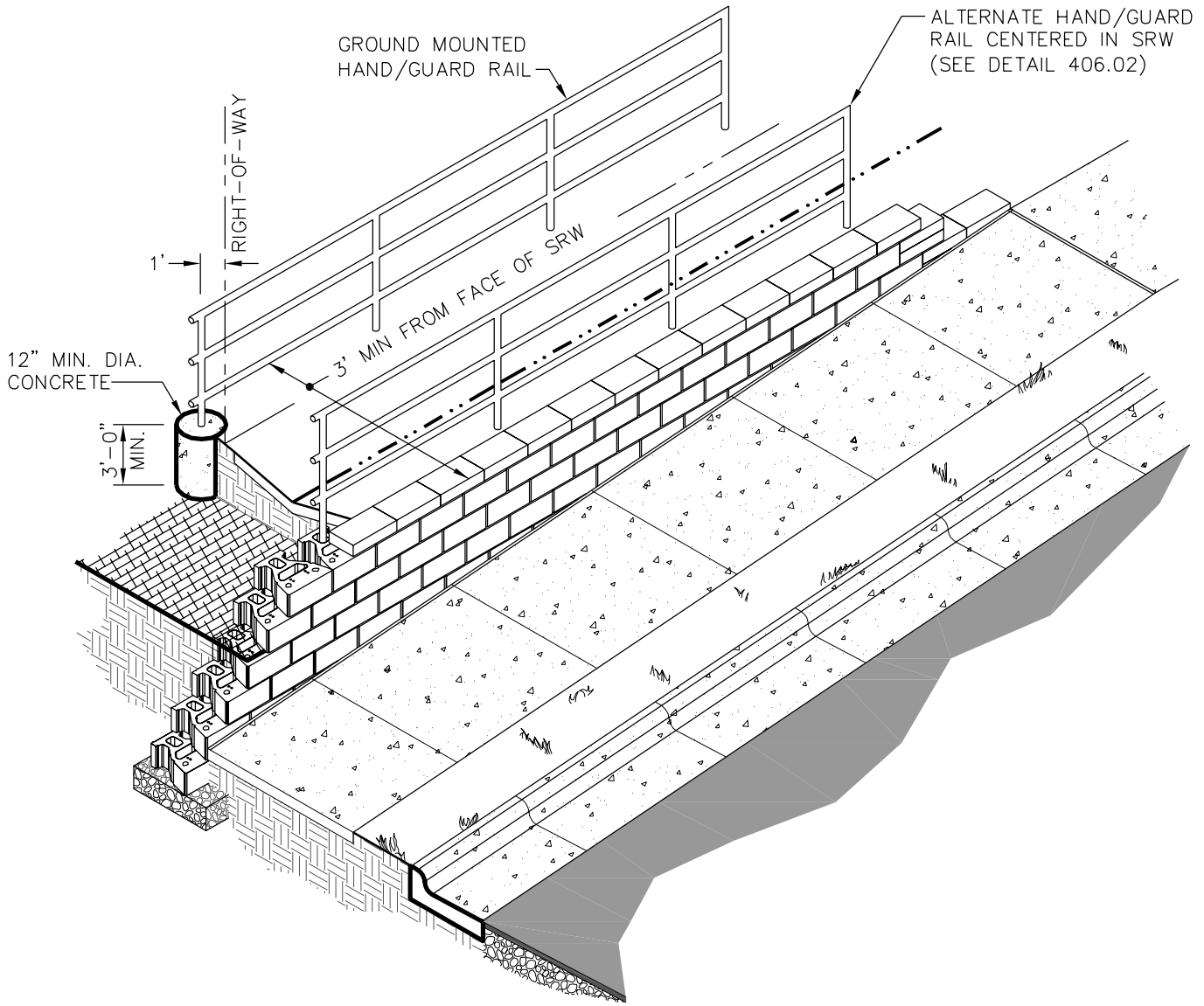

## TOWN of CLAYTON

USE WITH THE TOWN of CLAYTON STANDARD SPECIFICATIONS ONLY

# SEGMENTAL RETAINING WALLS IN RIGHT-OF-WAY

SCALE: Not To Scale	DETAIL # 2 406.01
REVISION DATE: July, 2010	SHEET #: 3 of 3